

FastTrack™

Low-Profile Trench Drain System



Fast

Channel joints connect easily with no hardware needed

Rebar anchors secure channels in place during the concrete pour

Versatile

Tough, lightweight, HDPE channels are U.V. and chemical resistant

A variety of grating options for all types of traffic

Low Profile

Provides an engineered drainage solution for shallow slabs or depth-restricted applications.

Durable covers protect channels during rough-in. Slide to overlap joints and help maintain alignment.



Supply

Drainage

Support

Specialties

www.siouxchief.com

TAKE THE FIELD.



Dimensions

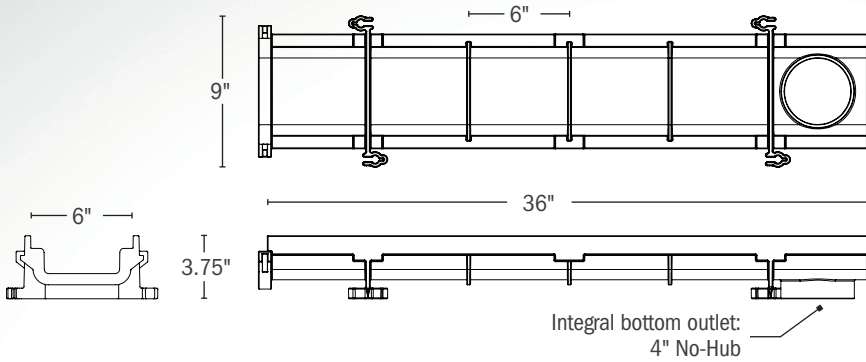

Add 1" to overall height when using 865-F grate frame

System Notes

- The FastTrack system is designed for on-grade installations only
- Always install expansion joints on both sides of, and parallel to the channel, per specifications
- Slab should be sloped toward the channel on both sides to promote proper drainage
- Grate level should be set ~3/16" below finished slab level



865-NS1



865-GiS



865-F

Buying Information

ITEM NO.	DESCRIPTION	MIN. QTY.	CASE QTY.
CHANNELS			
865-NS1	Low-Profile Neutral Channel Section with Construction Cover - 36" Long	1	1
GRATES¹			
865-GiS	Slotted Ductile Iron Grate with Screws - 36" Long - Class D ²	1	1
865-GiC	Cross-Slot Ductile Iron Grate with Screws - 36" Long - Class C	1	1
865-GiD	Diagonal-Slot Ductile Iron Grate with Screws - 36" Long - Class C	1	1
865-GHS	Slotted HDPE Grate with Screws - 36" Long - Class A	1	1
865-GHC	Cross-Slot GF Polypro Grate with Screws - 36" Long - Class A	1	1
865-GSA	Angle-Slot Stainless Steel Grate with Screws - 36" Long - Class A	1	1
865-GSB	Stainless Steel Brick Slot Grate with Screws - 36" Long - Class C	1	1
865-GSBC	Stainless Steel Brick Slot Access Section (for use with 865-GSB) - 12" Long - Class C	1	1
865-GSD	Perforated Stainless Steel Grate with Screws - 36" Long - Class A	1	1
865-GSS	Slotted Stainless Steel Grate with Screws - 36" Long - Class A	1	1
865-GSSR	Reinforced Slotted Stainless Steel Grate with Screws - 36" Long - Class C	1	1
865-GGD	Perforated Galvanized Steel Grate with Screws - 36" Long - Class A	1	1
865-GGS	Slotted Galvanized Steel Grate with Screws - 36" Long - Class A	1	1
865-GGSR	Reinforced Slotted Galvanized Steel Grate with Screws - 36" Long - Class C	1	1
ACCESSORIES			
865-A	Grate Anchor - Stainless steel - Fits All Channels	1	20
865-C	Construction Cover - HDPE 36" Long - Fits All Channels	1	1
865-NSC	Flat, HDPE End Caps (pair) - Fits Low-Profile Channels	1	50
865-EG	Edge Guards - Stainless steel - 36" Long - Pair with Screws - Fits All Channels ³	1	1
865-F	Ductile Iron Grate Frame - 36" Long with Screws - Fits All Channels	1	1
865-S15	Replacement Screws for FastTrack Grates - 1/4-20 x 1-1/2" - Bag of 3 ⁴	1	100

1 Grate load class per DIN EN1433 | 2 Class D load rating requires use of 865-F grate frame | 3 Not for use with 865-F grate frame | 4 Screws are included with grates