

FastTrack™

Low-Profile Trench Drain System



Fast

Channel joints connect easily with no hardware needed

Rebar anchors secure channels in place during the concrete pour

Versatile

Tough, lightweight, HDPE channels are U.V. and chemical resistant

A variety of grating options for all types of traffic

Low Profile

Provides an engineered drainage solution for shallow slabs or depth-restricted applications.

Durable covers protect channels during rough-in. Slide to overlap joints and help maintain alignment.



Supply

Drainage

Support

Specialties

www.sioxchief.com

TAKE THE FIELD.



Dimensions

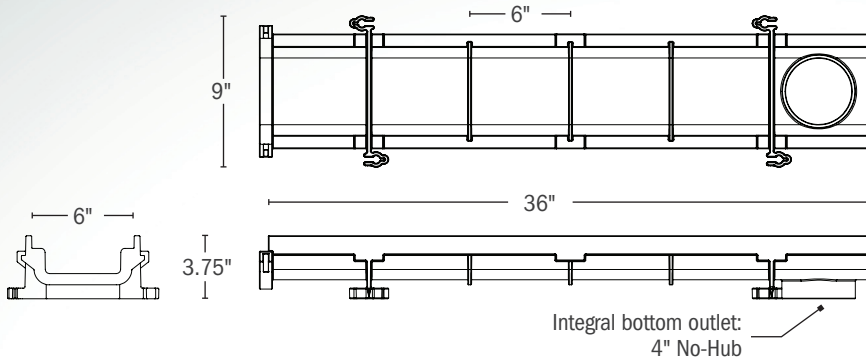

System Notes

- The FastTrack system is designed for on-grade installations only
- Always install expansion joints on both sides of, and parallel to the channel, per specifications
- Slab should be sloped toward the channel on both sides to promote proper drainage
- Grate level should be set $\sim 3/16"$ below finished slab level



865-NS1



865-GIS



865-F

Buying Information

ITEM NO.	DESCRIPTION	MIN. QTY.	CASE QTY.
CHANNELS			
865-NS1	Low-Profile Neutral Channel Section with Construction Cover - 36" Long	1	1
GRATES¹			
865-GIS	Slotted Ductile Iron Grate with Screws - 36" Long - Class D400 ²	1	1
865-GIC	Cross-Slot Ductile Iron Grate with Screws - 36" Long - Class C250	1	1
865-GICF	Cross-Slot Ductile Iron Grate with Screws - 36" Long - Class F900 ²	1	1
865-GiD	Diagonal-Slot Ductile Iron Grate with Screws - 36" Long - Class C250	1	1
865-GHS	Slotted HDPE Grate with Screws - 36" Long - Class A15	1	1
865-GHC	Cross-Slot GF Polypro Grate with Screws - 36" Long - Class A15	1	1
865-GSA	Angle-Slot Stainless Steel Grate with Screws - 36" Long - Class 15	1	1
865-GSB	Stainless Steel Brick Slot Grate with Screws - 36" Long - Class C250	1	1
865-GSBC	Stainless Steel Brick Slot Access Section (for use with 865-GSB) - 12" Long - Class C250	1	1
865-GSD	Perforated Stainless Steel Grate with Screws - 36" Long - Class A15	1	1
865-GSS	Slotted Stainless Steel Grate with Screws - 36" Long - Class A15	1	1
865-GSSR	Reinforced Slotted Stainless Steel Grate with Screws - 36" Long - Class C250	1	1
865-GGD	Perforated Galvanized Steel Grate with Screws - 36" Long - Class A15	1	1
865-GGS	Slotted Galvanized Steel Grate with Screws - 36" Long - Class A15	1	1
865-GGSR	Reinforced Slotted Galvanized Steel Grate with Screws - 36" Long - Class C250	1	1
ACCESSORIES			
865-A	Grate Anchor - Stainless steel - Fits All Channels	1	20
865-C	Construction Cover - HDPE 36" Long - Fits All Channels	1	1
865-NSC	Flat, HDPE End Caps (pair) - Fits Low-Profile Channels	1	50
865-EG	Edge Guards - Stainless steel - 36" Long - Pair with Screws - Fits All Channels ³	1	1
865-F	Ductile Iron Grate Frame - 36" Long with Screws - Fits All Channels	1	1
865-S15	Replacement Screws for FastTrack Grates - 1/4-20 x 1-1/2" - Bag of 3 ⁴	1	100

1 Grate load class per DIN EN1433 | 2 Class D400 or F900 load rating requires use of 865-F grate frame | 3 Not for use with 865-F grate frame | 4 Screws are included with grates