

# SHALLOW ESCUTCHEON

» 920/921 SERIES

TrimTite™

## SPECIFICATION

Sioux Chief 920/921 Series TrimTite shallow escutcheon shall be used where necessary on copper or steel stub outs. Escutcheons shall be molded from 100% corrosion proof material, having "shape-memory" to permanently retain its shape and grip on tube. Escutcheon shall be white in color and sized to work with CTS or IPS tubing.

## MATERIALS

Polyethylene

## DIMENSIONS

	3/8"	1/2"	3/4"	1"		
<b>920 Series</b>						
<b>A:</b> Outer diameter	2-1/2"	2-1/2"	2-1/2"	2-1/2"		
<b>B:</b> Inner diameter	3/8" CTS	1/2" CTS	3/4" CTS	1" CTS		
<b>C:</b> Thickness	9/16"	9/16"	9/16"	9/16"		
<b>921 Series</b>						
<b>A:</b> Outer diameter	2-1/2"	2-1/2"	3-1/2"	3-1/2"	3-1/2"	2"
<b>B:</b> Inner diameter	1/2" IPS	3/4" IPS	1" IPS	1-1/2" IPS	2" IPD	
<b>C:</b> Thickness	9/16"	9/16"	9/16"	9/16"	9/16"	

ITEM # SUBMITTED	_____
JOB NAME	_____
LOCATION	_____
ENGINEER	_____
CONTRACTOR	_____
PO#	_____ TAG _____

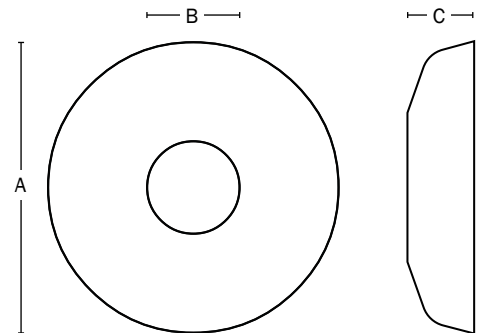

### Create Item Number

#### A-B

e.g. **920-2W**: White polyethylene shallow escutcheon for 1/2" CTS tube

#### TUBING TYPE A

**920** = for CTS tube

**921** = for IPS tube

#### NOMINAL TUBE SIZE B

**1W** = 3/8" <sup>1</sup>

**2W** = 1/2"

**3W** = 3/4"

**4W** = 1"

**6W** = 1-1/2" <sup>2</sup>

**7W** = 2" <sup>2</sup>

<sup>1</sup> Available for 920 Series only | <sup>2</sup> Available for 921 Series only