

# ADJUSTABLE ON-GRADE CLEANOUT

## 834 SERIES

FinishLine™

### SPECIFICATION

Sioux Chief 834 series FinishLine adjustable on-grade cleanout shall be used where necessary in drainage systems. Cleanout shall allow adjustment before and AFTER the concrete pour. Scoriated cleanout cover shall meet applicable load requirements for intended use. Cleanout shall include a slotted, polypropylene or optional brass cleanout plug, situated in base adapter. Designed in accordance with ASME A112.36.2M-2002

### MATERIALS

**Ring/cover:** Nickel-bronze, stainless steel, ductile iron

**Coring Plug:** High-impact polymer

**Head Adapter/Coring Sleeve/Base Adapter:** Ductile iron

**Cleanout plug:** Polypropylene, brass (optional)

### COVER LOAD RATING

**Nickel-Bronze / Stainless Steel:** 4,000 lbs. (Medium duty)

**Reinforced Nickel-Bronze / Stainless Steel:** 15,000 lbs. (Special duty)

**Ductile Iron:** 6,000 lbs. (Heavy duty)

**Reinforced Ductile Iron:** 15,000 lbs. (Special duty)

### DIMENSIONS

<b>A:</b> Connection (No-Hub)	3", 4"
<b>B:</b> Ring/cover diameter	
Round	6-1/2"
Square	6-5/8"
<b>C:</b> Base adapter height <sup>1</sup>	4-1/2"
<b>D:</b> Pre-pour height <sup>1</sup>	5-3/8" - 6-5/8"
<b>E:</b> After-pour height	
Round	0" - 1-1/4"
Square	5/16" - 1-1/4"
<b>F:</b> Cleanout plug	3-1/2" slotted

1 add 5/16" for Push-Joint connection

ITEM # SUBMITTED	_____
JOB NAME	_____
LOCATION	_____
ENGINEER	_____
CONTRACTOR	_____
PO#	_____ TAG _____



834-4DNR

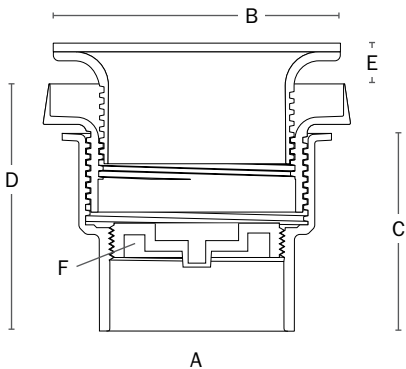

### Create Item Number

### 834-ABC

e.g. **834-4DNRB:** FinishLine adjustable cleanout with 4" No-Hub connection, round nickel-bronze cover, and brass plug

#### CONNECTION **A**

- ☐ **3D** = 3" No-Hub
- ☐ **63D** = 3" Push-Joint
- ☐ **4D** = 4" No-Hub
- ☐ **64D** = 4" Push-Joint

#### RING/COVER **B**

- ☐ **IR** = Round ductile iron
- ☐ **NR** = Round nickel-bronze
- ☐ **NQ** = Square nickel-bronze
- ☐ **SR** = Round stainless steel
- ☐ **SQ** = Square stainless steel

#### INSTALLED OPTIONS **C**

- ☐ **V** = Vandal-resistant cover screws
- ☐ **S** = Stamping (specify letters)
- ☐ **C** = Carpet marker
- ☐ **B** = Brass cleanout plug (in place of standard polypro)
- ☐ **Z** = Complies with BABAA<sup>2</sup>
- ☐ **P** = Push-Joint gasket for ABS/PVC pipe<sup>3</sup>
- ☐ **H** = Reinforced cover - Special Duty

#### Accessories - Available Separately:

- 832-P: Coring Plug / cleanout plug wrench
- 832-S4: Leveling shim kit
- 832-EX4: Ductile iron extension adapter
- 832-W: Flexible locating bristle kit

2 Only for cleanouts with round nickel-bronze covers | 3 In place of standard gasket for Push-Joint cleanouts