

Top 100 System Galvanized Steel Grate / C250 / Slotted - ADA

Product Specifications

Part No.:
865-T4GSCS (1 m) | 865-T4GS5CS (1/2 m)

Load Class:
 C250 (55,100 lbs) according EN 1433
 Certified by MPA-HB (independent laboratories)

Material: Galvanized Steel ST-37 **Weight:** 9.70 lbs (4.4kg)

Surface:
 Slot design (0.39" x 3.93")
 Slots according ADA Standards

Locking: Patented boltless grate locking system **Water intake:** 55.65 sq/in (359 cm²/m)

Use:
 This grate is developed for use with HydroTec TOP 100 channels made of fiber reinforced concrete with a galvanized steel edge protection.

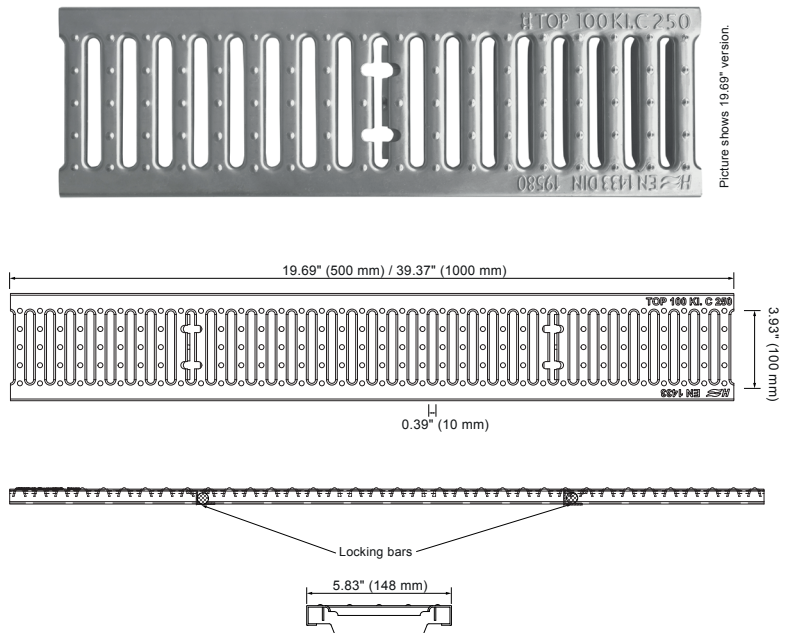

Fiber Reinforced Concrete Channel

Available heights(h):

- 3.15" (80mm)
- 4.33" (110mm)
- 6.30" (160mm)
- 7.28" (185mm)
- 8.27" (210mm)
- 9.25" (235mm)
- 10.24" (260mm)
- sloped (30 sections)

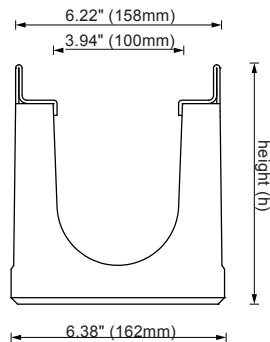

System Specifications

Grate Locking Tool (Part No. 865-TOOL):
 The Grate Locking Tool is made of galvanized steel. It's used to lock and unlock the grate.

Grate:
 The grate is made of galvanized steel and certified to EN 1433 Load Class C250.

Locking Bar (Part No. 865-4LR):
 Two locking bars fix the grate to the channel body. They're unlocked by the Grate Locking Tool .

TOP 100 Channel:
 The channel body is made of fiber reinforced concrete with a galvanized steel edge protection. Connecting profiles at the end of the channel guarantee an easy and fast installation.

