

CLEANOUT PLUG

878 & 879 SERIES

SPECIFICATION

Sioux Chief 878 & 879 Series Cleanout Plug shall be used where necessary in drainage systems. Plug shall be made from glass-fiber reinforced polypropylene material for durability and chemical resistance. Plugs shall have a large, raised square lug to facilitate installation and removal. Designed in accordance with ASTM F1498-08.

MATERIALS

Glass-fiber reinforced polypropylene.

INSTALLATION

For use in PVC/ABS or cast iron DWV systems. Use compatible thread sealing compound or PTEF tape. Install into female threads. Do not overtighten.

DIMENSIONS

A: Nominal size (MIP thread)	1½"	2"	3"	4"
B: Plug thickness	11/16"	11/16"	7/8"	7/8"
C: Overall height	15/16"	15/16"	15/8"	15/8"

ITEM # SUBMITTED	_____
JOB NAME	_____
LOCATION	_____
ENGINEER	_____
CONTRACTOR	_____
PO#	_____ TAG _____



878-S30

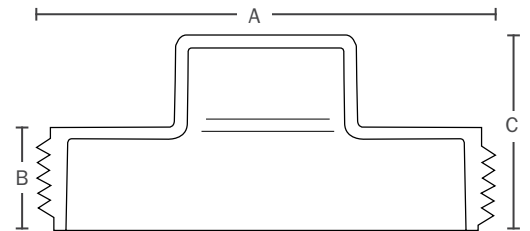

Create Item Number

87A-B

e.g. **878-S30**: 3" White polypro cleanout plug with raised square head

PLUG COLOR A

- 8 = White Polypro
- 9 = Black Polypro

SIZE B

- S15 = 1½" MIP Thread
- S20 = 2" MIP Thread
- S30 = 3" MIP Thread
- S40 = 4" MIP Thread